

NOTES:

1. THIS DOCUMENT IS FOR REFERENCE ONLY. MATERIAL SELECTION AND ASSEMBLY PROCEDURES ARE UP TO YOU. BUILD SMART, BE SAFE.
2. OVERALL VOLUME DIMENSIONS ROUNDED TO THE NEAREST 1/2" (1cm).
3. INDIVIDUAL PANEL DIMENSIONS ROUNDED TO NEAREST 1/16" (0.1cm).
4. ANGLE DIMENSIONS ROUNDED TO NEAREST DEGREE.
5. SEE SHEET 2 FOR VOLUME DETAIL
6. SEE SHEET 3 FOR PANEL DETAILS.
7. SEE SHEET 4 FOR PANEL DIMENSIONS.

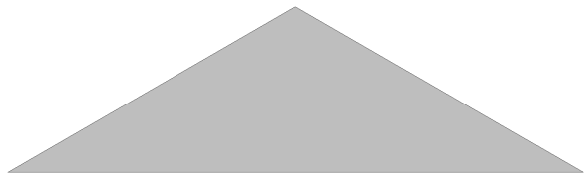
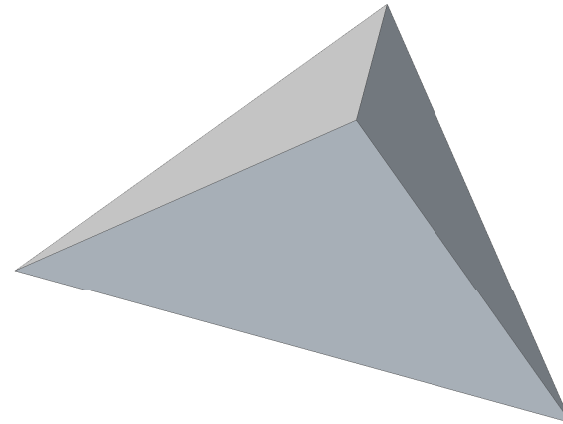
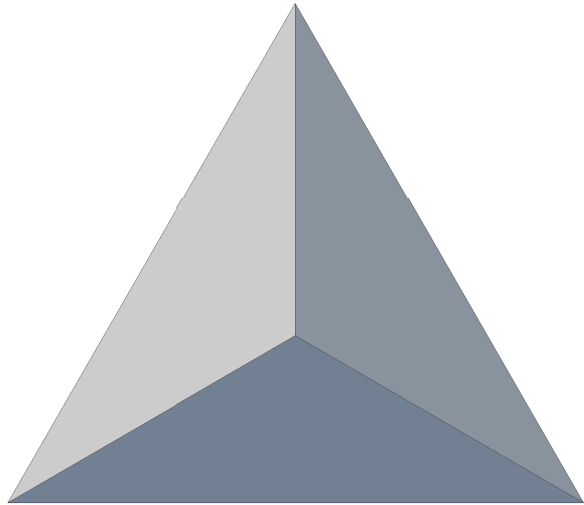

PROJECT:			
<b>EUCLID</b>			
PROJECTBACKROADS.COM			
DESCRIPTION			
PYRAMID, 3 PANEL, EQUILATERAL BASE, 24" WIDTH			
SIZE	REV	PART#	SHEET
<b>A</b>	-	<b>DWG-0004</b>	1 OF 4

NUMBER	Draft Angles			HEIGHT	
	Panel A	Panel B	Panel C	INCH	(cm)
VOL-0172	0°	0°	60°	12	(30.5)
VOL-0173	0°	0°	75°	6	(15.2)
VOL-0174	0°	15°	45°	16	(42.4)
VOL-0175	0°	15°	60°	10	(25.4)
VOL-0176	0°	15°	75°	5	(12.7)
VOL-0177	0°	30°	30°	18	(45.7)
VOL-0178	0°	30°	45°	13	(33.0)
VOL-0179	0°	30°	60°	9	(22.9)
VOL-0180	0°	30°	75°	5	(12.7)
VOL-0181	0°	45°	15°	16	(42.4)
VOL-0182	0°	45°	30°	13	(33.0)
VOL-0183	0°	45°	45°	10	(25.4)
VOL-0184	0°	45°	60°	8	(20.3)
VOL-0185	0°	45°	75°	4	(10.2)
VOL-0186	0°	60°	15°	10	(25.4)
VOL-0187	0°	60°	30°	9	(22.9)
VOL-0188	0°	60°	45°	8	(20.3)
VOL-0189	0°	60°	60°	6	(15.2)
VOL-0190	0°	75°	15°	5	(12.7)
VOL-0191	0°	75°	30°	5	(12.7)
VOL-0192	0°	75°	45°	4	(10.2)
VOL-0193	15°	15°	30°	19	(48.3)
VOL-0194	15°	15°	45°	14	(35.6)
VOL-0195	15°	15°	60°	9	(22.9)
VOL-0196	15°	15°	75°	5	(12.7)
VOL-0197	15°	30°	30°	15	(38.1)
VOL-0198	15°	30°	45°	11	(27.9)
VOL-0199	15°	30°	60°	8	(20.3)
VOL-0200	15°	45°	30°	11	(27.9)
VOL-0201	15°	45°	45°	9	(22.9)
VOL-0202	15°	45°	60°	7	(17.8)
VOL-0203	15°	60°	30°	8	(20.3)
VOL-0204	15°	60°	45°	7	(17.8)
VOL-0205	15°	60°	60°	6	(15.2)
VOL-0206	30°	30°	30°	12	(30.5)
VOL-0207	30°	30°	45°	10	(25.4)
VOL-0208	30°	30°	60°	7	(17.8)
VOL-0209	30°	45°	45°	8	(20.3)
VOL-0210	30°	45°	60°	6	(15.2)
VOL-0211	30°	60°	45°	6	(15.2)
VOL-0212	30°	60°	60°	5	(12.7)
VOL-0213	45°	45°	45°	7	(17.8)
VOL-0214	45°	45°	60°	6	(15.2)
VOL-0215	45°	60°	60°	5	(12.7)
VOL-0216	60°	60°	60°	4	(10.2)

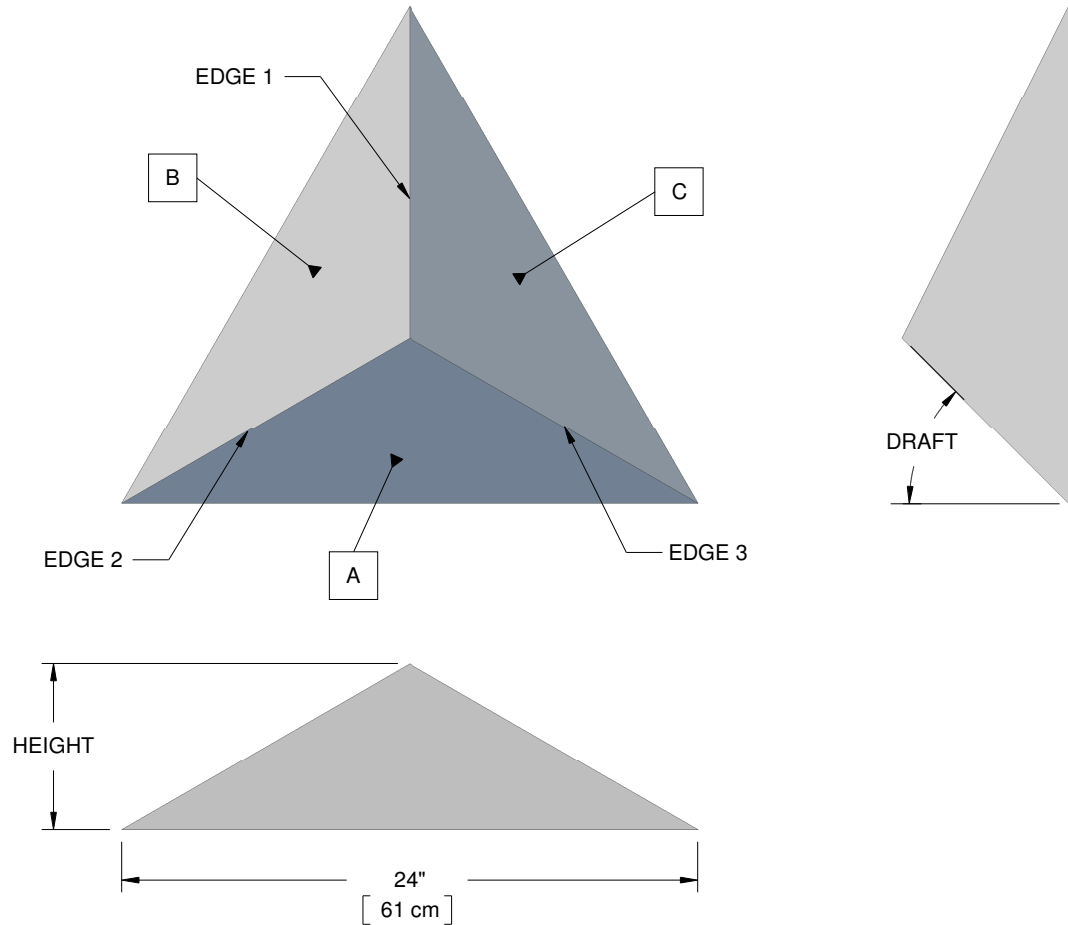

PROJECT:			
<b>EUCLID</b>			
PROJECTBACKROADS.COM			
DESCRIPTION			
PYRAMID, 3 PANEL, EQUILATERAL BASE, 24" WIDTH			
SIZE	REV	PART#	SHEET
<b>A</b>	-	<b>DWG-0004</b>	<b>2 OF 4</b>

# PANELS

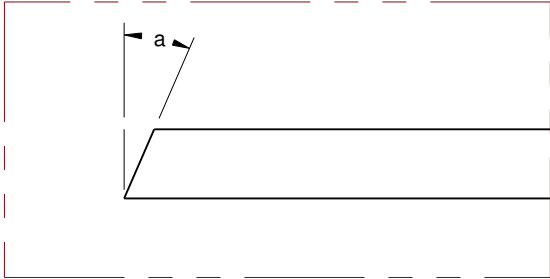
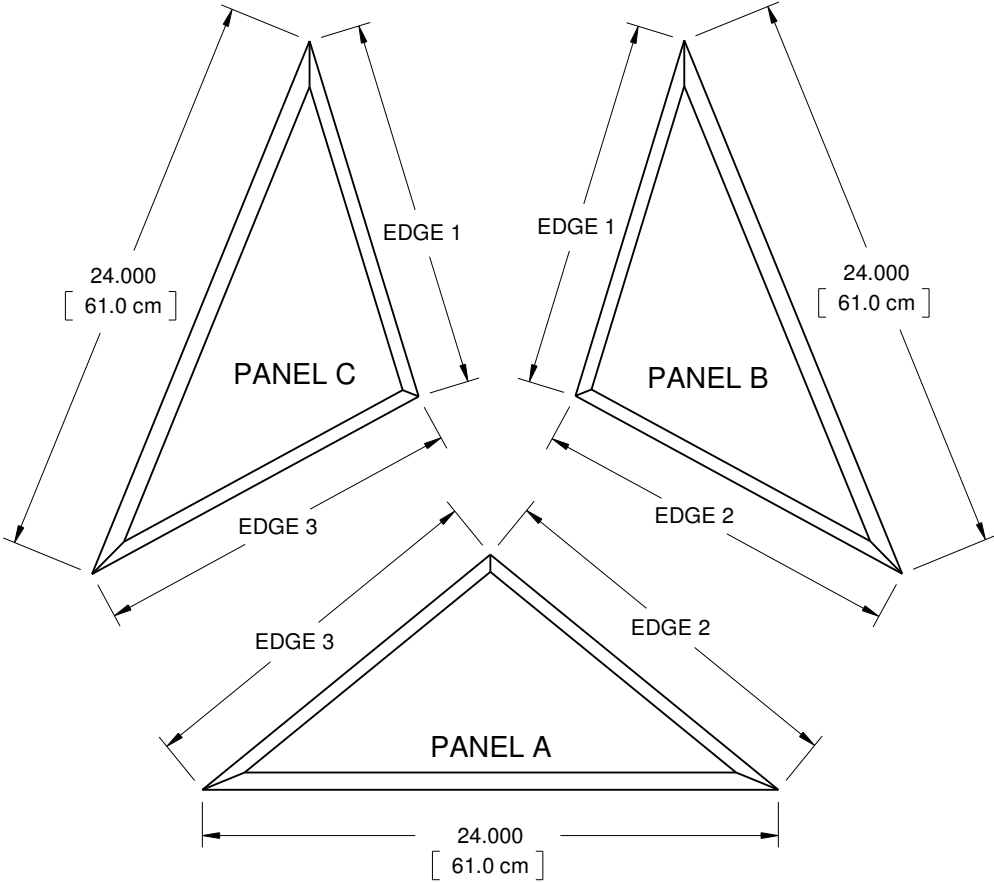

CUT ANGLE

PROJECT:			
<b>EUCLID</b>			
PROJECTBACKROADS.COM			
DESCRIPTION			
PYRAMID, 3 PANEL, EQUILATERAL BASE, 24" WIDTH			
SIZE	REV	PART#	SHEET
<b>A</b>	-	<b>DWG-0004</b>	3 OF 4

# PANEL DIMENSIONS

NUMBER	BASE ANGLES			EDGE 1			EDGE 2			EDGE 3		
				LENGTH		ANGLE (a)	LENGTH		ANGLE (a)	LENGTH		ANGLE (a)
	Panel A	Panel B	Panel C	INCH	(cm)		INCH	(cm)		INCH	(cm)	
VOL-0172	0°	0°	60°	26.813	(68.2)	42°	12.000	(30.5)	30°	26.813	(68.2)	42°
VOL-0173	0°	0°	75°	24.625	(62.6)	46°	5.563	(14.1)	30°	24.625	(62.6)	46°
VOL-0174	0°	15°	45°	27.375	(69.5)	40°	17.188	(43.6)	31°	25.063	(63.6)	35°
VOL-0175	0°	15°	60°	24.813	(63.1)	45°	10.875	(27.6)	31°	23.250	(59.0)	38°
VOL-0176	0°	15°	75°	23.813	(60.5)	49°	5.438	(13.8)	31°	23.000	(58.4)	41°
VOL-0177	0°	30°	30°	27.500	(69.8)	41°	21.625	(54.9)	32°	21.625	(54.9)	32°
VOL-0178	0°	30°	45°	24.813	(63.0)	46°	15.813	(40.2)	32°	20.125	(51.1)	35°
VOL-0179	0°	30°	60°	23.438	(59.5)	51°	10.813	(27.5)	32°	20.125	(51.1)	38°
VOL-0180	0°	30°	75°	23.063	(58.6)	56°	5.813	(14.7)	32°	21.313	(54.2)	41°
VOL-0181	0°	45°	15°	27.375	(69.5)	40°	25.063	(63.6)	35°	17.188	(43.6)	31°
VOL-0182	0°	45°	30°	24.813	(63.0)	46°	20.125	(51.1)	35°	15.813	(40.2)	32°
VOL-0183	0°	45°	45°	23.250	(59.0)	52°	15.875	(40.3)	35°	15.875	(40.3)	35°
VOL-0184	0°	45°	60°	22.375	(56.8)	58°	11.625	(29.5)	35°	17.000	(43.2)	38°
VOL-0185	0°	45°	75°	22.375	(56.8)	63°	6.688	(17.0)	35°	19.438	(49.4)	41°
VOL-0186	0°	60°	15°	24.813	(63.1)	45°	23.250	(59.0)	38°	10.875	(27.6)	31°
VOL-0187	0°	60°	30°	23.438	(59.5)	51°	20.125	(51.1)	38°	10.813	(27.5)	32°
VOL-0188	0°	60°	45°	22.375	(56.8)	58°	17.000	(43.2)	38°	11.625	(29.5)	35°
VOL-0189	0°	60°	60°	21.625	(54.9)	64°	13.438	(34.1)	38°	13.438	(34.1)	38°
VOL-0190	0°	75°	15°	23.813	(60.5)	49°	23.000	(58.4)	41°	5.438	(13.8)	31°
VOL-0191	0°	75°	30°	23.063	(58.6)	56°	21.313	(54.2)	41°	5.813	(14.7)	32°
VOL-0192	0°	75°	45°	22.375	(56.8)	63°	19.438	(49.4)	41°	6.688	(17.0)	35°
VOL-0193	15°	15°	30°	24.688	(62.7)	37°	21.188	(53.8)	33°	24.688	(62.7)	37°
VOL-0194	15°	15°	45°	22.563	(57.4)	40°	15.375	(39.0)	33°	22.563	(57.4)	40°
VOL-0195	15°	15°	60°	21.938	(55.6)	45°	10.375	(26.4)	33°	21.938	(55.6)	45°
VOL-0196	15°	15°	75°	22.313	(56.7)	49°	5.500	(14.0)	33°	22.313	(56.7)	49°
VOL-0197	15°	30°	30°	22.313	(56.7)	41°	19.313	(49.0)	37°	19.313	(49.0)	37°
VOL-0198	15°	30°	45°	21.188	(53.9)	46°	14.875	(37.8)	37°	18.813	(47.8)	40°
VOL-0199	15°	30°	60°	21.000	(53.3)	51°	10.688	(27.1)	37°	19.250	(49.0)	45°
VOL-0200	15°	45°	30°	21.188	(53.9)	46°	18.813	(47.8)	40°	14.875	(37.8)	37°
VOL-0201	15°	45°	45°	20.500	(52.0)	52°	15.313	(38.9)	40°	15.313	(38.9)	40°
VOL-0202	15°	45°	60°	20.375	(51.7)	58°	11.563	(29.4)	40°	16.563	(42.1)	45°
VOL-0203	15°	60°	30°	21.000	(53.3)	51°	19.250	(49.0)	45°	10.688	(27.1)	37°
VOL-0204	15°	60°	45°	20.375	(51.7)	58°	16.563	(42.1)	45°	11.563	(29.4)	40°
VOL-0205	15°	60°	60°	20.063	(51.0)	64°	13.313	(33.8)	45°	13.313	(33.8)	45°
VOL-0206	30°	30°	30°	18.313	(46.6)	41°	18.313	(46.6)	41°	18.313	(46.6)	41°
VOL-0207	30°	30°	45°	18.188	(46.1)	46°	14.750	(37.4)	41°	18.188	(46.1)	46°
VOL-0208	30°	30°	60°	18.750	(47.6)	51°	11.000	(27.9)	41°	18.750	(47.6)	51°
VOL-0209	30°	45°	45°	18.063	(45.8)	52°	15.188	(38.6)	46°	15.188	(38.6)	46°
VOL-0210	30°	45°	60°	18.438	(46.9)	58°	11.813	(30.0)	46°	16.375	(41.5)	51°
VOL-0211	30°	60°	45°	18.438	(46.9)	58°	16.375	(41.5)	51°	11.813	(30.0)	46°
VOL-0212	30°	60°	60°	18.563	(47.1)	64°	13.375	(34.0)	51°	13.375	(34.0)	51°
VOL-0213	45°	45°	45°	15.500	(39.3)	52°	15.500	(39.3)	52°	15.500	(39.3)	52°
VOL-0214	45°	45°	60°	16.375	(41.6)	58°	12.438	(31.6)	52°	16.375	(41.6)	58°
VOL-0215	45°	60°	60°	16.813	(42.6)	64°	13.688	(34.8)	58°	13.688	(34.8)	58°
VOL-0216	60°	60°	60°	14.438	(36.7)	64°	14.438	(36.7)	64°	14.438	(36.7)	64°

DECIMAL	FRACTION
0.063	1/16
0.125	1/8
0.188	3/16
0.250	1/4
0.313	5/16
0.375	3/8
0.438	7/16
0.500	1/2
0.563	9/16
0.625	5/8
0.688	11/16
0.750	3/4
0.813	13/16
0.875	7/8
0.938	15/16

PROJECT:			
<b>EUCLID</b>			
PROJECTBACKROADS.COM			
DESCRIPTION			
PYRAMID, 3 PANEL, EQUILATERAL BASE, 24" WIDTH			
SIZE	REV	PART#	SHEET
<b>A</b>	-	<b>DWG-0004</b>	<b>4 OF 4</b>